

VFT-1000 Transfer Unit

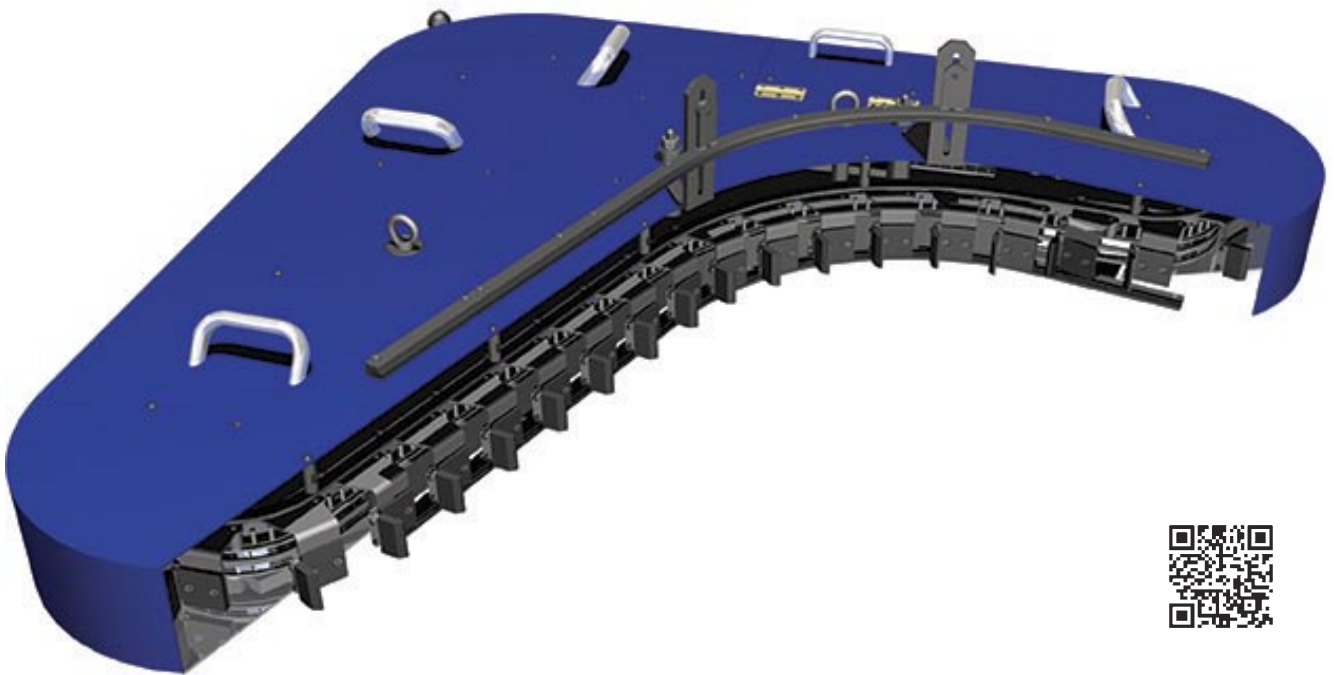

The VFT-1000 Transfer unit is purposely designed for handling containers produced on Triple Gob (TG) and Quad Gob (QG) production machines. The gradual collection of the containers at the entrance to the transfer, along with a smooth, large radius curve with unique finger motion at the exit, ensures that bottles are transferred onto the cross conveyor accurately and without loss.

Features and Benefits

- 3 finger sizes
- 2 finger spacing configurations
- Designed for TG or QG production
- For Double Gob operation transfer finger spacing capable of matching IS machine conveyor spacing
- Unique finger retract system
- 'Quick Change' fingers
- Transfers containers from 40mm to 96mm diameter
- Adjustable top and bottom ware guides
- Spacing reduced through transfer
- Reduced job set-up time
- Enhanced container stability
- Reliable cross conveyor spacing
- Minimal spares holding
- Consistent ware handling up to 1,000 BPM
- Flask production at 300-450 BPM
- Intermediate fingers from 12 fingers and above
- For optimum performance we recommend use with Sheppee Cross Conveyor
- Recommended service intervals 12 months
- Carbon or SSB insulation

VFT-1000 Transfer Unit

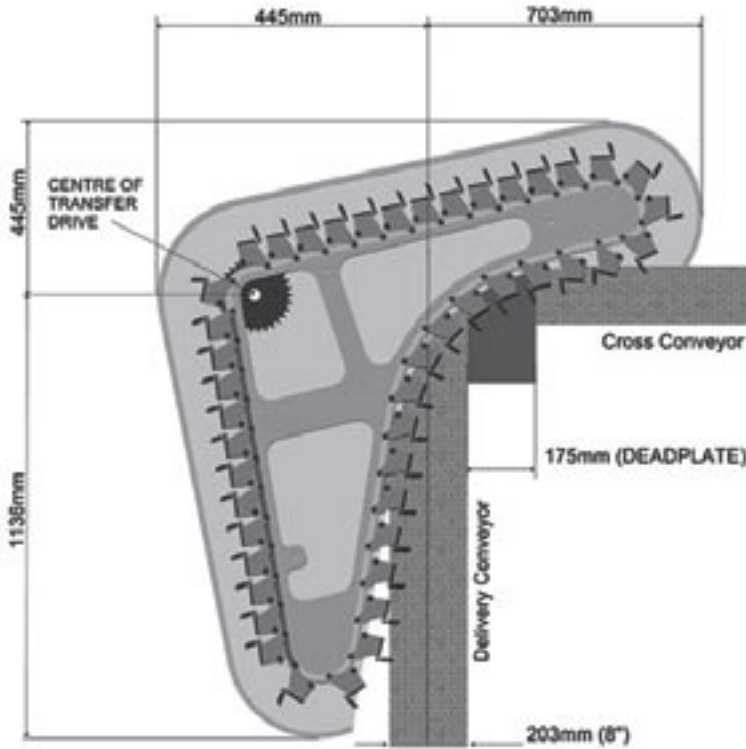

Technical Specifications

Operating speed:	Up to 1000 BPM
Standard chain length:	157.5"
Standard chain pitch:	3/4" Duplex
Number of teeth on sprocket:	30
Chain movement per revolution of drive shaft:	22.5"

Installation Details and Service Requirements

- Connection to Lincoln Lubrication
- Can be driven by servo or synchronous motor drive
- Can work with all I.S. machine drive systems
- Transfer can be used in conjunction with a Sheppee ITD-8000-2 Transfer Drive Unit.

*See chart below

Chain Length Data

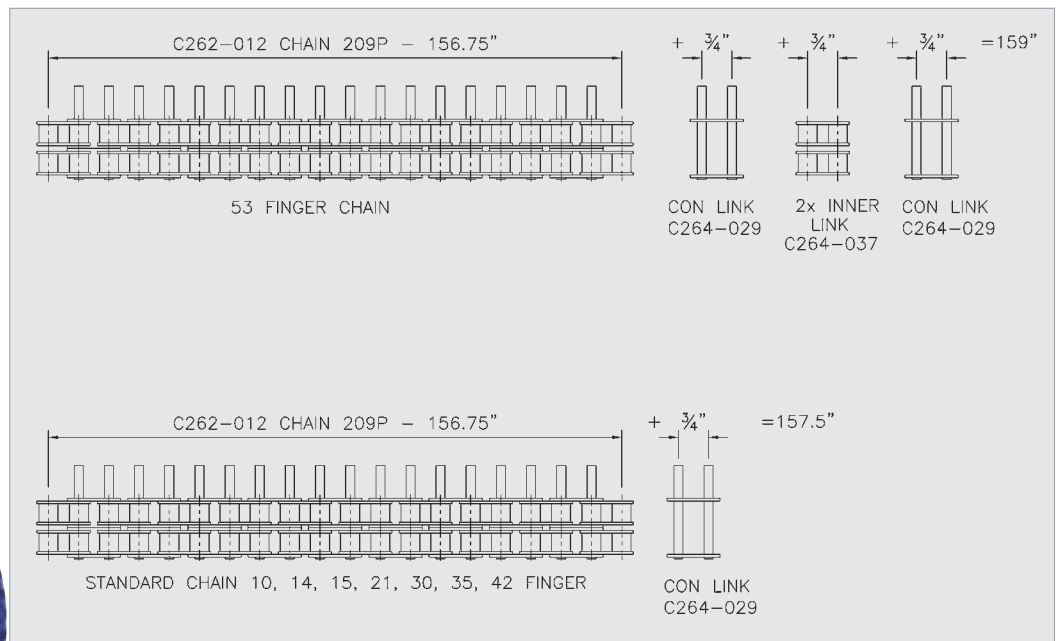

VFT-1000 Transfer Unit

Finger Spacing Options

Number of Fingers	Finger Spacing	Finger Part Number	Intermediate Finger Part Number	Container Size Limits
53 <i>(159" chain required for this spacing)</i>	3"	VFT-1008-01L/R		52mm
42	3 ³ / ₄ "	VFT-1008-01L/R		68mm
35	4 ¹ / ₂ "	VFT-1008-02L/R		78mm
30	5 ¹ / ₄ "	VFT-1008-02L/R	VFT-1013L/R	92mm***

*For SSB (stainless steel braid) option, add "-SSB" to the end of the part number.

** When using SSB insulation, container size limits should be reduced by 2mm.

***For diameter 92mm-96mm special pusher pad required.

Contact Material Options

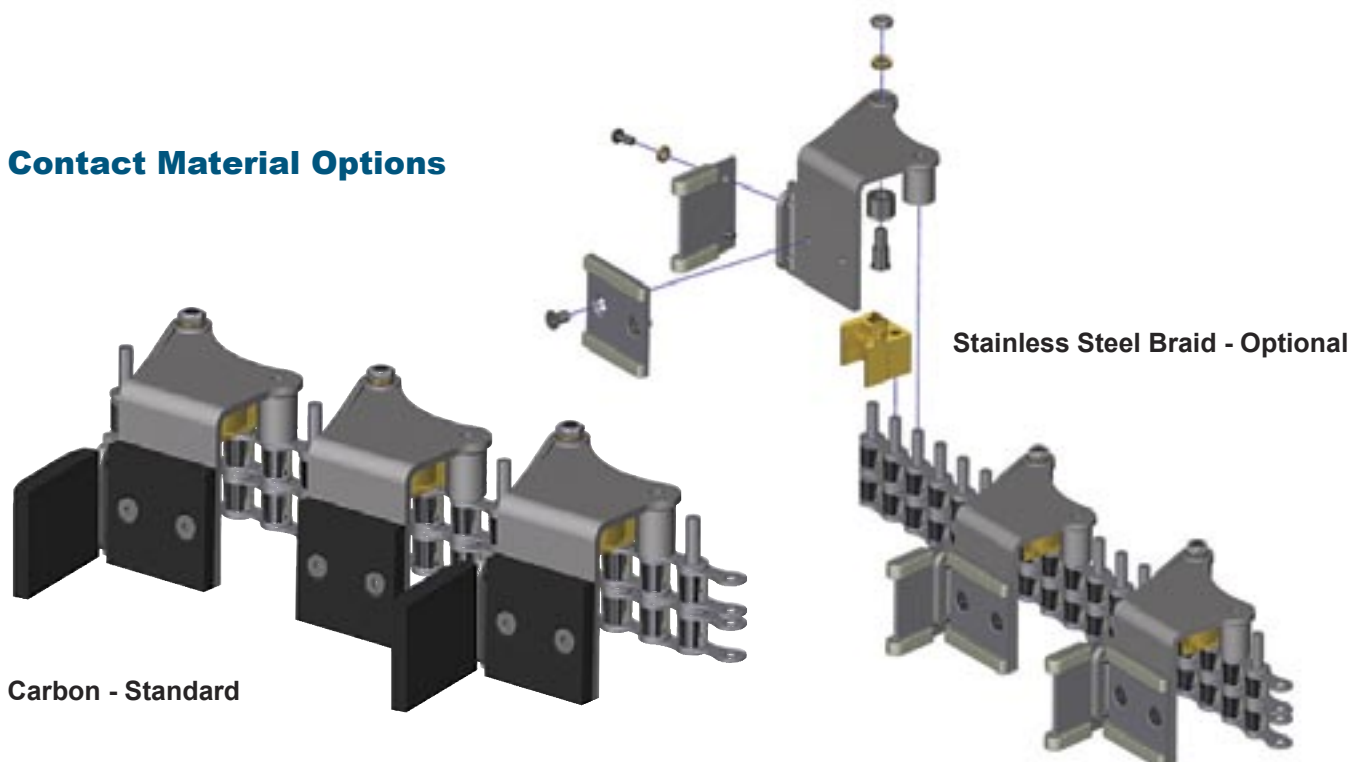

VFT-1000 Transfer Unit

Variable and Consumable Item Identification Chart

Part: VFT-1008-01-L/R
Size 01 Finger Assembly



Part: VFT-1008-02-L/R
Size 02 Finger Assembly

Part: VFT-1013L/R
Intermediate Finger



Part: HST-117-01
Size 01 Pusher Pad



Part: HST-117-03
Size 03 Pusher Pad

Part: HST-022-INV
Back Pad



157.5" Chain
Part: VFT-1011

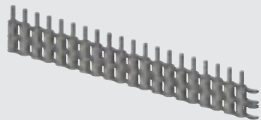

159" Chain
Part: VFT-1011-53

Ware Guide Insulator
Part: VFT-007



Ware Guide Insulator
Part: VFT-008



Finger Carrier
Part: HST-028



For Stainless Steel Braid add SSB to the part number.

For all additional parts refer to assembly drawings.

Container size limits

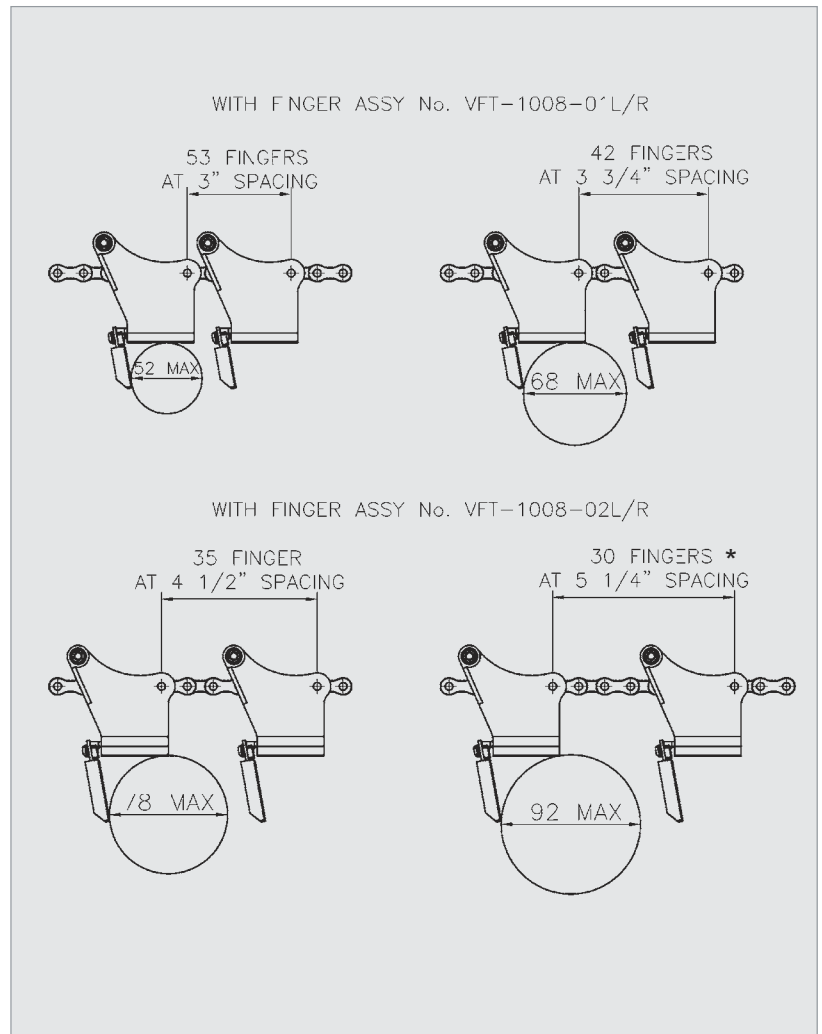

*For diameter 93mm-96mm special pusher pad required



UK: Halifax Way, Airfield Business Park, Elvington, York, YO41 4AU
T: +44 1904 608 999 F: +44 1904 608 777
E: sales@sheppee.com

China: Sheppee-AP Sales & Support Centre, Shenzhen, China,
T: +86 755 8222 5976 E: sales@si-ap.com